

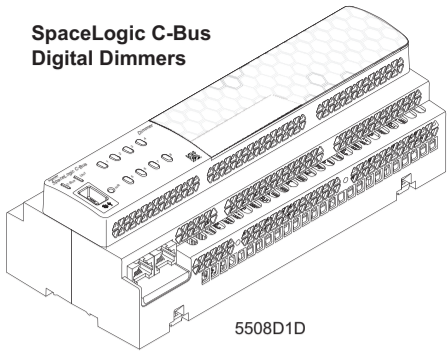

SpaceLogic C-Bus Digital Dimmers



5508D1D



1

Load	Compatible Load Types	Load Rating	Lamp Rating	
			at 230Vac	at 110Vac
LED	Dimmable LED Lamps and Luminaires	1A per channel	230W	110W
	Incandescent / Halogen Lamps		230W	110W
	Halogen Lamps with electronic transformers		230W	110W
	Halogen Lamps with dimmable iron core transformers		230W	110W

2

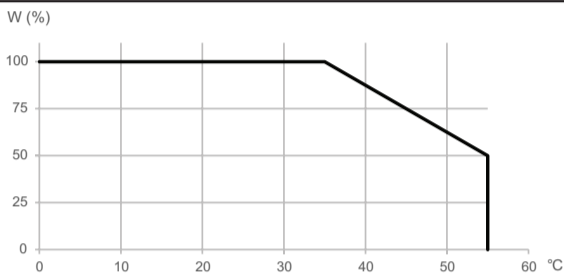

3

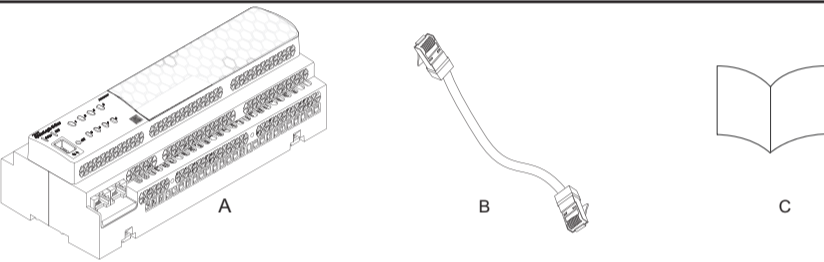

4

T-Blocks used on 110V ac connections only Refer ⑦

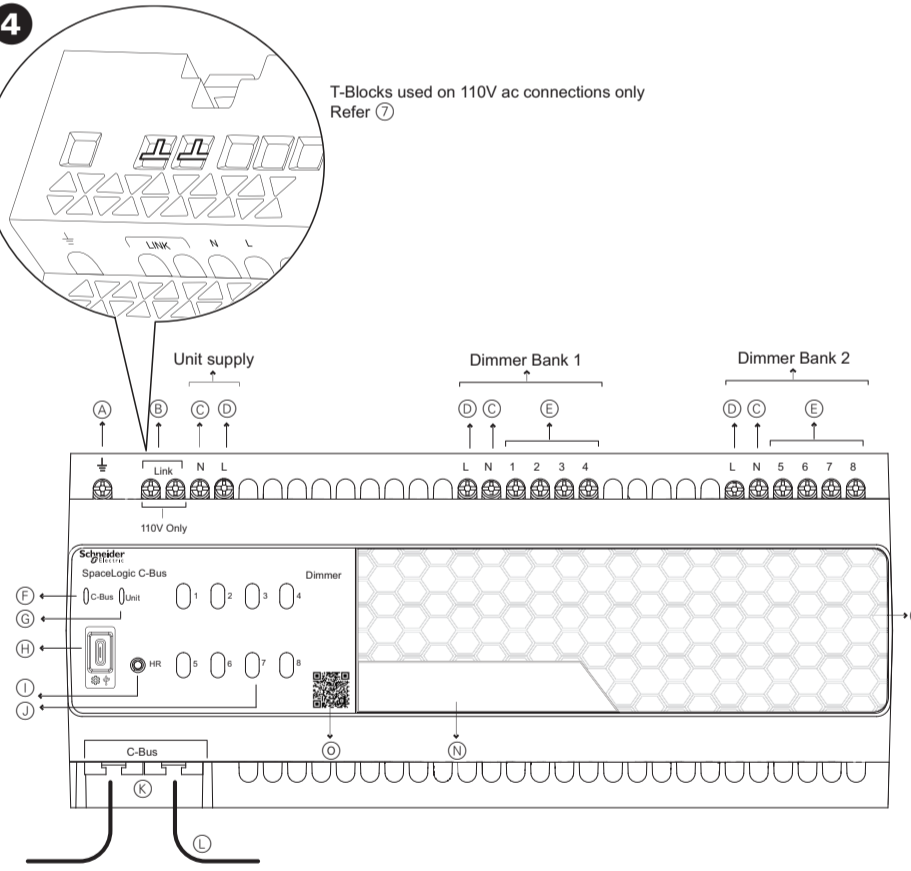

5

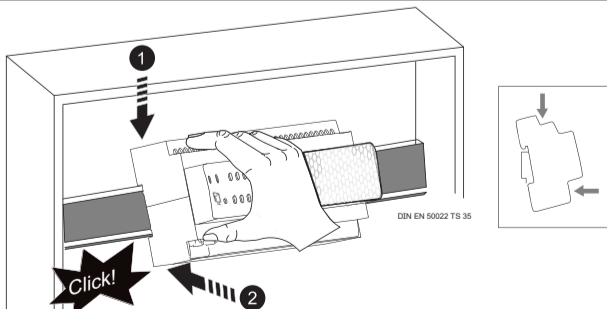

6

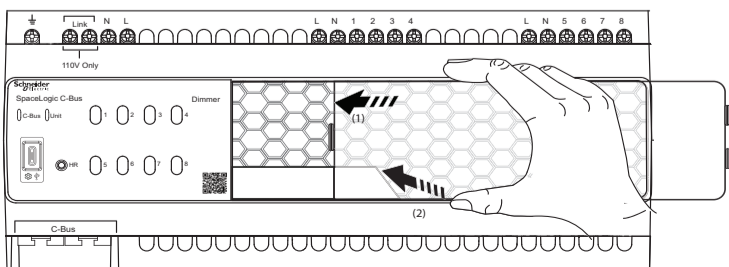

en SpaceLogic C-Bus DIN Rail Digital Dimmer 8 Channel 1A

Introduction

The SpaceLogic C-Bus Digital Dimmers are new-generation lighting control dimmers that allow full customisation for elegant control of dimmable LED lights and other light sources.

Product Range

Catalog Number	Description
5508D1D	Dimmer, SpaceLogic C-Bus, DIN rail mount, adjustable trailing/leading edge phase control, 8 channel, 1A per channel, inbuilt switchable C-Bus power supply.

For Your Safety

HAZARD OF ELECTRIC SHOCK, EXPLOSION, OR ARC FLASH

- This product must be installed and serviced by appropriately qualified and/or licensed professional in accordance with the local wiring rules.
- Isolate the electrical supply before doing any work on the product.
- Ensure that the product has been correctly installed and tested for safe operation before reconnecting the electrical supply.
- Do not use this product for any other purpose than specified in this instruction.
- Pay attention to the specifications and wiring diagrams related to the installation.
- Do not attempt to open the product casing or perform any action on the internal components of the product.

Failure to follow these instructions will result in death or serious injury.

INCORRECT C-BUS CABLE INSTALLATION

The C-Bus network cabling is classified as Separated Extra-Low Voltage (SELV) wiring. To maintain this requirement, the approved C-Bus cable must be used.

- Ensure that adequate separation and/or segregation of the C-Bus cable from other wiring (for example Low Voltage wiring) is maintained throughout the entire installation.
- Ensure the C-Bus network cable is installed in accordance with the SELV wiring rules and regulations of the jurisdiction.

Failure to follow these instructions can result in death, serious injury, or equipment damage.

NOTICE

To prevent the possibility of intentional or unintentional interference with the configuration or operation of the C-Bus installation, this equipment should be installed in a location with appropriate access control.

Failure to follow these instructions can result in equipment damage.

NOTICE

MEGGER TESTING
Megger testing must never be performed on any cable while connected to the product as it could degrade the performance of the product and/or the network.

- For indoor use only.
- Use a location free of water, humidity, direct sunlight, and heavy dust.
- Make sure there is adequate ventilation, and the internal temperature rise is limited.

Failure to follow these instructions can result in equipment damage.

NOTICE

MAXIMUM LOAD RATINGS APPLY
Ensure that the number of lighting loads connected to a single device does not exceed the maximum load rating of each channel.

Failure to follow these instructions can result in equipment damage.

NOTICE

Failure to follow these instructions can result in equipment damage.

1 Compatible Loads

2 Derating Table

If the anticipated ambient temperature levels are higher than operating temperature, it is advised to refer the derating table guidelines to adjust the dimmer load accordingly.

Note: The operating calorific values and the heat load must be considered when designing the distribution board.

3 Package Contents

- A Dimmer
- B C-Bus Patch Cable
- C Instruction Sheet

4 About the Dimmer

- A Earth
- B Wire Link Terminal for 110V
- C Neutral
- D Active Line
- E Load Connections
- F C-Bus Indicator
- G Unit Indicator
- H USB (Type-C) Connector
- I Hard Reset Button
- J Channel Button Indicators
- K C-Bus Connectors 2x RJ-45
- L C-Bus Network Cable
- M Transparent Removable Cover

- N Space for Labelling
- O QR code for product details and serial number

5 Mounting DIN Rail

The dimmer should only be installed horizontally on the mounting rails (type DIN EN 50022 TS 35) inside a distribution board.

6 Remove / Place cover for labelling

To remove, push the cover to the left side and lift the cover upwards supporting the sides of the cover. To place back the cover, refer illustration.

7 230V Wiring

WARNING

EQUIPMENT DAMAGE HAZARD
Do not break T-Block terminal and/or insert a wire-link unless using the dimmer with 110 V a.c unit supply voltage.
Failure to follow these instructions can result in death, serious injury, or equipment damage.

Phase Independent Dimming Banks

The 8 Channel Dimmer has 2 banks of channels; each bank requires Active and Neutral connection (which provide power to the channels, loads) and has 4 load connections. The dimming banks may be connected to different phases.

4 Dimming bank 1 between terminals (1-4), Dimming bank 2 between terminals (5-8)

Note: The dimming banks may be connected from different phases to the dimmer's unit power supply.

8 110V Wiring

To use the dimmer with a 110V a.c. unit supply, break the T-Block terminal using a screwdriver and connect a wire link between terminals 4 and 5.

WARNING

EQUIPMENT DAMAGE HAZARD
When breaking the T-block in the terminal, be careful not to damage other terminal blocks.
Failure to follow these instructions can result in death, serious injury, or equipment damage.

C-Bus Network Connection

Connection to the C-Bus network is made via one of the RJ45 connectors. Use only C-Bus certified cable, which is identifiable by its pink sheath. For C-Bus cable, refer

Catalogue number: 5005C305B (solid)
Catalogue number: 5005C305BST (stranded)

Pinouts and cable conductor assignments are provided in 10. The RJ45 connectors are internally connected.

Note: It is recommended that the Remote Override (On/Off) connections be maintained for correct operation of these services across the C-Bus network, even if they are not intended to be used.

First Power Up

Default Factory Setting of the dimmer

By default, the integrated 200mA C-Bus Power supply is disabled. It can be enabled or disabled via the front panel and/or the SpaceLogic C-Bus Commission software.

By default, all dimmer channels are set to Trailing Edge mode by default. The dimmer enables selecting the dimming mode per channel, Trailing edge (TE), or Leading edge (LE) compatible with the load changed via the front panel and/or the SpaceLogic C-Bus Commission software.

Note: The dimmer channels do not automatically change mode when the connected load type is incompatible. If the connected load is incompatible with the currently selected dimming mode, the channel will shut down and indicate an error.

By default, the C-Bus Clock Generator in the unit is disabled. It can be enabled or disabled via the front panel and/or the SpaceLogic C-Bus Commission software.

Note: Channel indicators show channel status only when the channel is on.

Refer to the diagnosis section (a) for information regarding other indications.

Before operating the load, ensure its compatibility with the dimming mode and check the correctness of its wiring.

Load wiring check and Dimming Mode (TE/LE) Selection

To check the wiring and operation of the connected load, short press (<0.5s) the channel button to toggle the state of the channel.

The load should turn on, and the channel button will illuminate in the colour corresponding to the currently selected dimming mode (Yellow = TE, Green = LE). If the load does not turn on but the channel indicator stays green or yellow, check the wiring.

If the selected mode is incompatible with the attached load, the channel may shut down and the indicator will slowly flash red, indicating a mode error.

If the mode needs to be changed, press and hold the channel button for >10s. The channel will turn off briefly and turn on again in the opposite mode. Refer to diagnosis section (a).

After the channels and load wiring on first power, the following Unit and C-Bus indicators are observed.

Unit Indicator ④ (G)	
State/colour	Meaning
Green	Unit powered, C-Bus power supply Enabled
Yellow	Unit powered, C-Bus power supply Disabled
C-Bus Indicator ④ (F)	
Solid (not flashing)	C-Bus Voltage OK (>20V)
Red	No C-Bus clock detected, Host Online
Green	C-Bus clock detected, Host Online
Yellow	C-Bus clock detected, Host Offline

Note: For more information on other indications, refer to the diagnosis section (c)

9 Switching of the inbuilt C-Bus power supply and C-Bus system clock if required

Ensure adequate C-Bus power supply is enabled in the bus by referring to the indication on the unit and

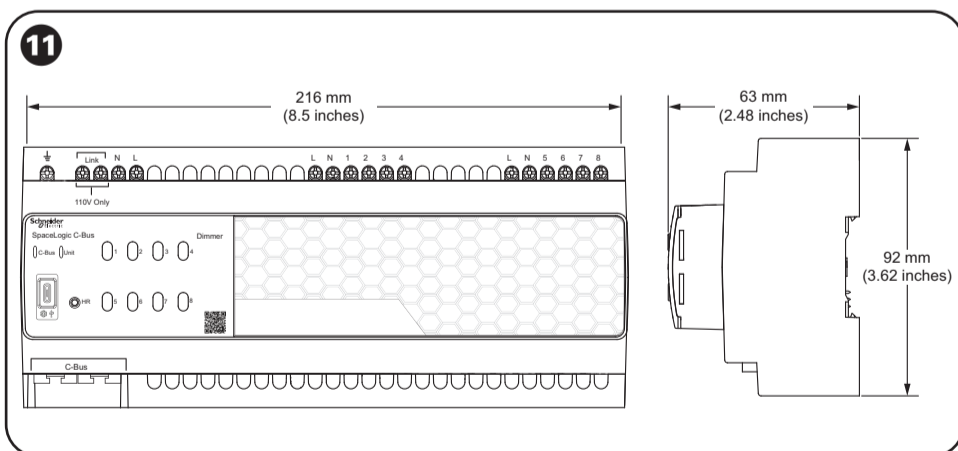
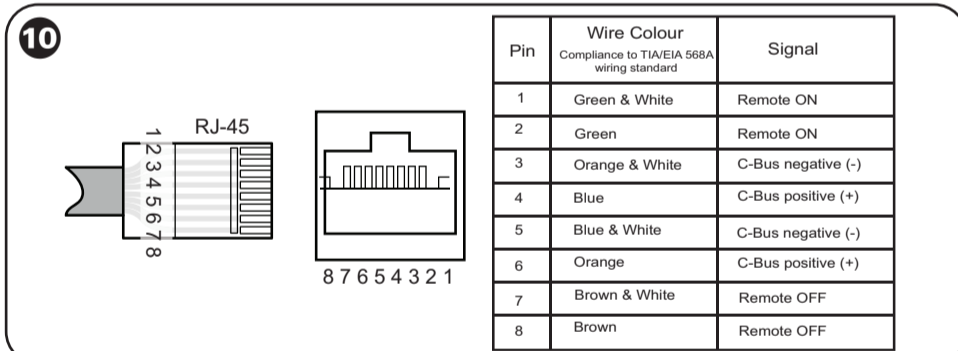
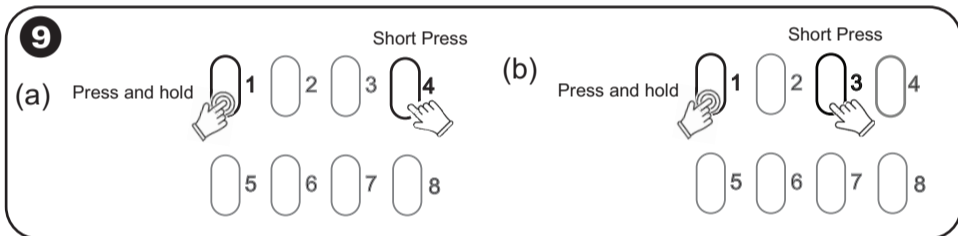
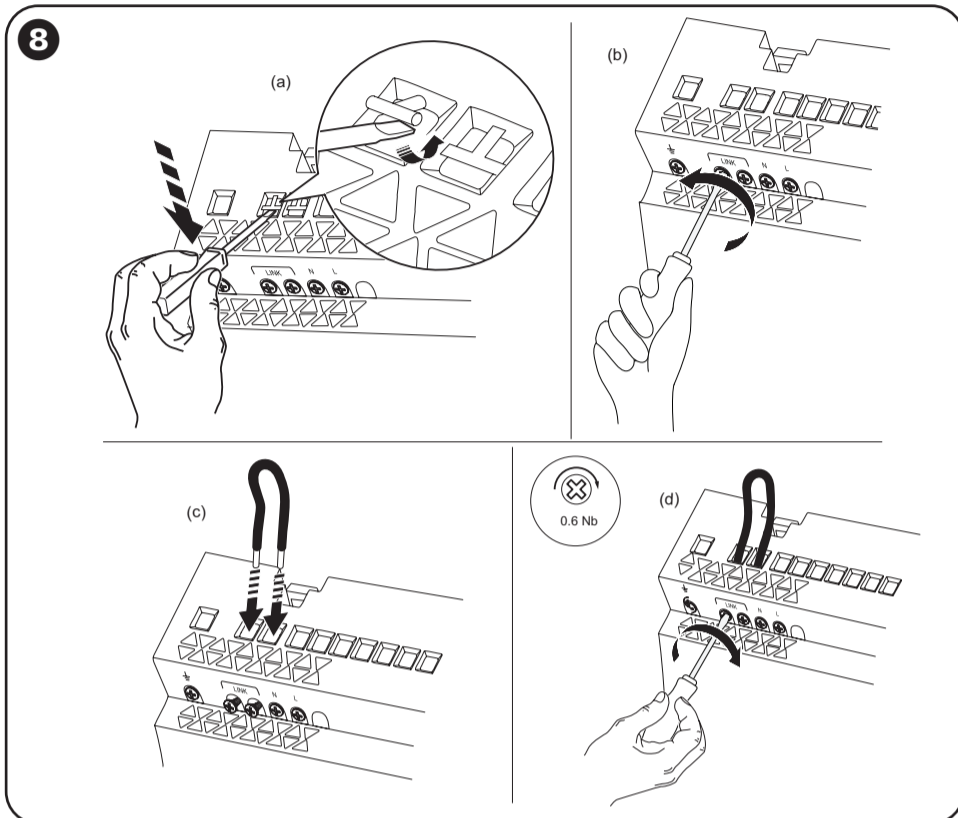
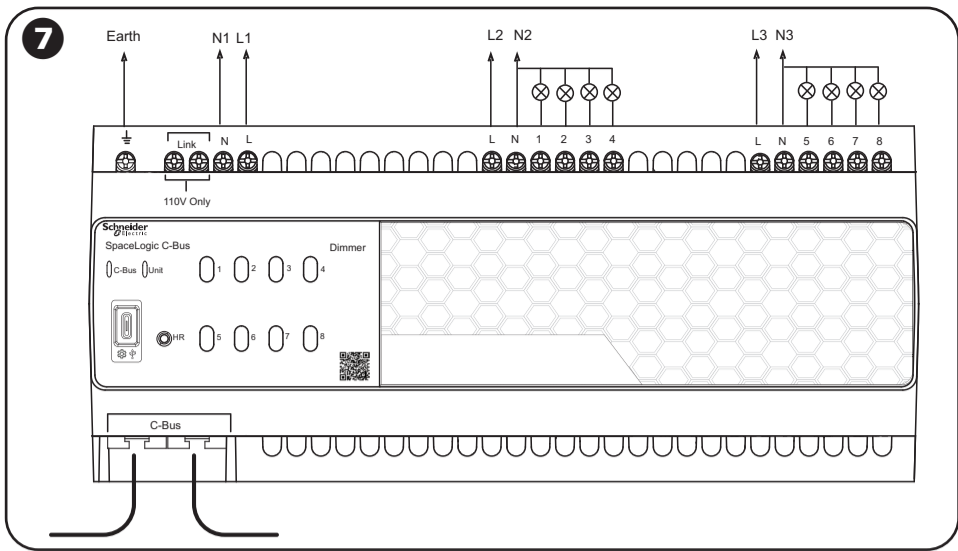

the bus design by checking the right amount of power supplies enabled. In case of low C-Bus bus power indication, switch the inbuilt C-Bus Power supply in the dimmer.

Note: If the inbuilt switchable C-Bus power supply is enabled, the dimmer supplies power upto 200 mA to the network when connected to the mains.

How to enable/disable C-Bus power supply

The integrated C-Bus Power Supply can be enabled or disabled via the front panel by performing a short press on the top right channel button whilst holding down the top left channel button to toggle the enabled state. Refer 9(a)

The enabled status of the integrated C-Bus Power Supply is shown on the Unit Indicator. Refer to diagnosis section (b).

The C-Bus Indicator state shows the state of the network voltage. If the C-Bus Indicator is flashing or off, the network voltage is too low, meaning there is insufficient C-Bus Power. additional power supplies may need to be enabled.

NOTE: It is important to ensure that no more than 2A of total C-Bus Power Supply capacity is enabled/connected to any one C-Bus network.

How to enable/disable the C-Bus system clock generator (if required)

The system clock is used to synchronize data communication over a C-Bus network. If a system clock is required, it can be enabled from the SpaceLogic C-Bus Commission software and the indicator buttons on the dimmer.

The integrated C-Bus Clock generator can be enabled or disabled via the front panel by performing a short press on the top second-to-right button whilst holding down the top left channel button to toggle the enabled state. Refer 9(b)

Configuration and Commissioning

Configuration and Commissioning of the unit is done by the C-Bus connection using the "SpaceLogic C-Bus Commission" software which can be downloaded from the URL: <http://www.se.com>

The unit can be powered by the USB Type-C connection to perform the configuration prior to the installation.

Local Override

The channel indicator buttons on the front of the dimmer toggle the corresponding channel on and off, providing local override capability.

Each button illuminates only when its respective channel is in the ON state.

Local channel indicator buttons perform different functions depending on how they are pressed.

Operation	Function
Short-press (< 0.5 second)	A single short press toggles the state of a channel.
Double Short-press	Two short presses in series return the channel to the C-Bus network level.
Long-press (1-2 second)	A Long Press on any local indicator button for one second or more returns all channels to the C-Bus network level.

Note: Double short-press and long-press operations only apply when the dimmer/channel is in local override mode.

By default, any C-Bus commands received by the dimmer will override local toggle changes. In this case, only the channel associated with the received commands will revert to the C-Bus network state. This option may be disabled in software. Refer to Priority of Operating Modes.

Remote Override

The extra two pairs of the C-Bus network cable provide high priority override functions for most C-Bus Output units.

The Green & Green/White pair is used for the Remote ON function.

The Brown & Brown/White pair is used for the Remote OFF function.

Connecting either pair to the C-Bus negative pair activates the corresponding function.

The SpaceLogic C-Bus Network Automation and Application Controllers provide facilities to control these overrides.

If this function is to be used, care should be taken to preserve continuity of these pairs between all Output Units in the installation.

NOTE: Care should also be taken throughout the installation to ensure these pairs are not left unterminated, as this may result in inadvertent triggering of the override functions.

Priority of Operating Modes

The output status of a C-Bus DIN Rail Digital Dimmer can be changed by:

- Pressing a C-Bus button.
- Activating any of the local toggle buttons (local override).
- Using the Remote Override facility.

The priority ranking of these actions is as follows:

Mode	Priority	Function
Thermal overload	1 (highest)	Channel automatically dimmed
Remote OFF	2	All channels OFF
Remote ON	3	All channels ON
Local override	4	Toggles the channel
C-Bus Input Unit (Wall plates, sensor etc)	5	Control the channel

Power-Up Load Status

The dimmer has on-board non-volatile memory, which by default is used to store the operating state of each channel in case of power loss.

On restoration of power, the dimmer waits approximately 5s for power to stabilise before restoring the channel states.

Firmware Update

The SpaceLogic C-Bus Commission software will notify if a firmware update is required. The update requires a connection to the USB Type C connector on the dimmer and is performed using the SpaceLogic C-Bus Commission software. All required firmware files will be included and authenticated as part of the latest SpaceLogic C-Bus Commission software release.

The Reset button is provided only for recovery purposes and should not be pressed unless instructed. Detailed instructions for the update process are included with the SpaceLogic C-Bus Commission software.

Diagnosis

Thermal Monitoring

Operation of the dimmer at elevated temperatures or voltages outside of specification may cause the over-temperature protection circuitry to operate. C-Bus Digital Dimmers incorporate a thermal monitoring protective mechanism. This reduces the load brightness (wind-back) under conditions of inadequate ventilation or excessive ambient temperature. If the excessive ambient temperature continues and the winding back function is insufficient, the dimmer will shut down for protection.

Indications and their meaning

a. Channel Indicators 4 (J)

State/colour	Meaning
On, Green	Channel On, LE mode
On, Yellow	Channel On, TE mode
Slow Flash, Red	Channel shutdown due to incorrect mode (inductive load running in TE mode)
Off	Channel off
On, Red	Channel Offline. Normally due to no mains supply to channel
Fast Flash, Red	Channel shutdown due to overcurrent. Normally due to excessive inrush or load/wiring fault (short circuit)
Fast Flash, Yellow	Channel shutdown due to over temperature condition. Normally due to excessive load and/or inadequate ventilation
Slow Flash, Yellow	Channel operating at reduced setting due to over temperature condition. Normally due to excessive load and/or inadequate ventilation

b. Unit Indicators 4 (G)

State/colour	Meaning
Off	No power to device
Red	Unit Powered, Configuration Error
Slow Flash, Red/Green	Internal temperature has exceeded over-temperature threshold. C-Bus power supply enabled
Slow Flash, Red/Yellow	Internal temperature has exceeded over-temperature threshold. C-Bus power supply disabled
Green, Short Flash Red	Internal temperature has exceeded over-temperature threshold. Override Active, C-Bus power supply enabled
Yellow, Short Flash Red	Internal temperature has exceeded over-temperature threshold. Override Active, C-Bus power supply disabled
Green, Short Flash Off	Override active. C-Bus power supply enabled
Yellow, Short Flash Off	Override active. C-Bus power supply disabled
Fast Flash, Green	Secondary firmware update in progress

c. C-Bus Indicator 4 (F)

State/colour	Meaning
Off	No C-Bus voltage present or unit not powered
Steady Flash	C-Bus Voltage marginal (15-20V)
Short Flash	C-Bus Voltage critical (<15V)

Specifications

Parameter	Description
Nominal Mains Voltage and Frequency	230V a.c ± 10%, 50Hz ± 3Hz 110V a.c ± 10%, 60Hz ± 3Hz
C-Bus Input Operating Voltage:	20 - 36 V dc
C-Bus Input Operating Current :	20mA
C-Bus Power Supply (if enabled):	200 mA at 27-35 V dc
Load Rating	Up to 1A per channel
Dimmer Technology	Adjustable per channel -Trailing edge (TE) / (LE) Leading edge phase control
Compatible Loads	Dimmable LED lamps and luminaires, incandescent/ halogen lamps, halogen lamps with electronic transformers, halogen lamps with dimmable iron core transformers.
Operating Temperature	-5 to 55°C with derating according to 2
Operating Humidity	10% to 93% non-condensing
Dimensions (WxHxD)	216 x 92 x 63mm (8.5 x 3.62 x 2.48 inches)
Mains terminals	Accommodates 2 x 1.5mm ² or 1 x 2.5 mm ² (2 x 16 AWG or 1 x 13 AWG) Screw driver used for the terminal is Philips PH1
C-Bus connections	2 x RJ45 connectors
Product Compliance	CE UK CA
No user-serviceable parts inside.	

Schneider Electric Industries SAS

If you have technical questions, please contact the Customer Care Centre in your country.

se.com/contact

Warranty

For Warranty information and service, visit se.com/contact.

Declaration

This product is in compliance with the applicable directive and standards. Declaration of conformity can be downloaded on: se.com/docs.